



**GARY MANN  
REAL ESTATE**

**Cody Lamb  
Realtor**

**305 E Third Ave  
Moses Lake, WA 98837**

**Cell 509-855-1096  
Fax 509-766-2905  
codylamb@gmail.com**

**CodyLamb.com  
Moses Lake Listings.com**

# Residential Client Detail Report

Listings as of 01/27/10 at 12:55am

**Lot: 14**

**Unit #:**

**522 Earl Rd Moses Lake 98837**



[See Additional Pictures](#)

<b>Status</b>	Active	<b>Beds</b>	3	<b>List Price</b>	114,500
<b>Listing#</b>	29110949	<b>Baths</b>	1.00	<b>Sold Price</b>	
<b>County</b>	Grant	<b>Fireplaces</b>		<b>Year Built</b>	1955

<b>Style</b>	10-1 Story	<b>Appx. SQFT</b>	1118
<b>Bldg Type.</b>	Built On Lot	<b>SQFT Src.</b>	County
<b>Covd Prkg.</b>	Off-Street Parking	<b>Acreage</b>	0.165
<b>Project</b>	Knolls Vista 13th Add	<b>Lot Size</b>	7200
<b>New Const.</b>			60x120

<b>School Information:</b>		<b>Area</b>	297
<b>School District</b>	Moses Lake	<b>Community</b>	Knolls Vista
<b>Elementary</b>		<b>Map:</b>	1
<b>Jr. High</b>		<b>Grid:</b>	A-1
<b>High School</b>		<b>Pool</b>	

<u>Room Locations</u>			<u>Property Details</u>		
	L	M	U		
<b>Bedrooms</b>		3		<b>Heating/Cooling</b>	Baseboard
<b>Baths (Full)</b>		1		<b>Energy Source</b>	Electric
<b>Baths (3/4)</b>				<b>Terms</b>	Cash Out, Conventional
<b>Baths (1/2)</b>				<b>Exterior</b>	Wood Products
<b>Dining</b>				<b>Roof Type</b>	Composition
<b>Living</b>				<b>Water</b>	Public
<b>Kitchen</b>				<b>Sewer</b>	Sewer Connected
<b>KtnEatSp</b>		X		<b>Floor Covering</b>	Vinyl, Wall to Wall Carpet
<b>Master</b>				<b>Appliances</b>	
<b>Family</b>				<b>View</b>	Territorial
<b>Rec. Room</b>				<b>Basement</b>	
<b>Den/Office</b>				<b>Architecture</b>	
<b>Fireplace</b>				<b>Water Heater</b>	Electric
<b>Utility</b>		X		<b>Lease Equip.</b>	
<b>ExFinRoom</b>				<b>ApprvAssry Unit</b>	
<b>Entry</b>		X			
<b>Bonus Room</b>					
<b>Tax Year</b>	2009			<b>Annual Taxes</b>	1208
				<b>Sr. Exemption No</b>	
				<b>Homeowner Dues</b>	
				<b>Monthly Rent</b>	

**Directions :** Stratford Road south. Left on Valley Rd. Left on Central. Right on Loop. Left on Earl. Property on right.

**Interior Features :**

**Site Features :** Fenced-Partially

**Marketing Remarks :** Great Starter Home or Investment Property. Spacious Open Kitchen with New Cabinets & Countertops. New Carpet & Vinyl throughout Fresh Interior Paint. New Tile Tub surround. Be sure to see the pictures!

Cody Lamb / Gary Mann Real Estate  
 Lot Sizes And Square Footage Are Estimates.  
 Information From Reliable Sources, But Not Guaranteed.  
 Copyright ©2010 Rapattoni Corporation. All rights reserved.

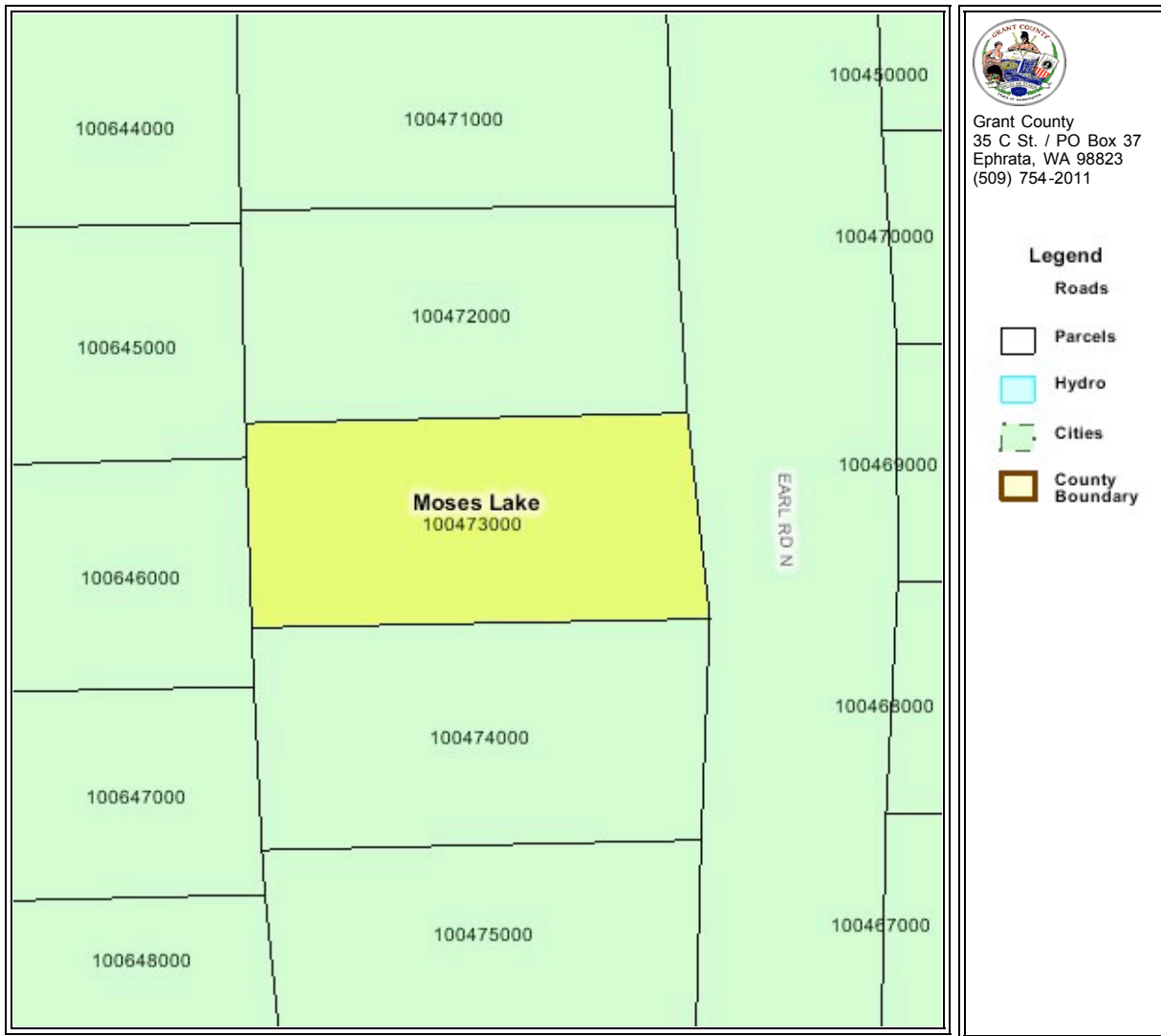

**SITE INFORMATION**

Parcel #: 100473000	Reval: 5	Zoning:	Fire:
Legal: LOT 14;KNOLLS VISTA 13TH ADD;60X120	Year Built: 1955	Comp Plan:	Port: 10
Imp Acres: 0.00	Sq Ft.: 01118	Shoreline:	Park:
Uimp Acres: 0	# Rms: 06	Sensitive:	Library: L
Land Value: \$22,000	# BdRms: 03	Critical:	Cemetery:
Imp Value: \$77,455	F- # BthRms: 1 H- 0		Mosquito: 1
Land Use: RESIDENTIAL-SINGLE UNIT	Quality: 02	Tax Status:	
Owner: RILEY RUTH	Assoc MH: 0	Taxcode: 0073	Appraised Value: \$99,455
Address: C/O LESLIE S THOMPSON	T/R/S:	City/County: Moses Lake	Tax Value: \$99,455
OREGON CITY OR 97045	X Coord:	School: Moses Lake School District (161)	Levy: 12.14552
Situs: 00000522 EARL RD N	Y Coord:	Hospital: 1	***Tax Amount: \$1,207.93

\*\*\*Base Tax Amount NOT valid for paying taxes. Does not include Special Asssments and/or changes. Contact Treasurer's Office for current tax amount.\*\*\*

**DISCLAIMER**

These maps should not be construed as legal advice or legal opinion on any specific facts or circumstances. The contents are intended for general information purposes only, and you are urged to consult your own lawyer concerning your own situation and any specific questions you may have. Infrastructure records, drawings, and other documents have been gathered over many decades, using differing standards for quality control, documentation and verification. All of the data provided represents current information in a readily available format. While the data is generally believed to be accurate, occasionally it proves to be incorrect; thus its accuracy is not warranted. Prior to making any property purchases or investments based in full or in part upon the material provided, it is specifically advised that you independently field verify the information contained in county records.

This page was generated on: 1/27/2010

“I DO MORE FOR MY SELLERS”



Strategic Internet Marketing



Trusted Locally for Over 25 Years

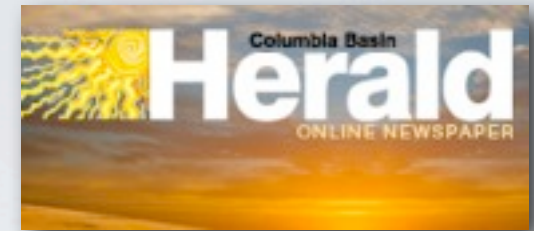

Aggressive Local Marketing

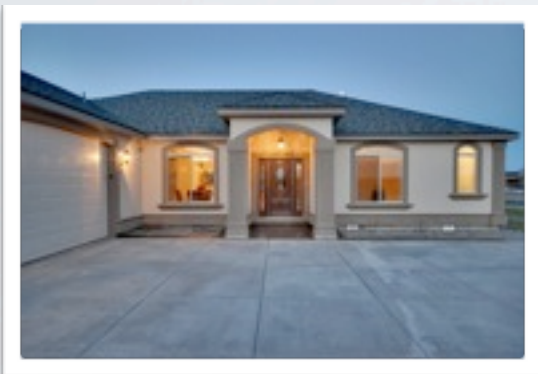

High-Definition Photos



Focused on Results



Your Best Interest at Heart

Cody Lamb, Full-Time Realtor 509-855-1096 cell/text  
#1 in Buyer transactions in Moses Lake, 2009.